

V20130101

CATALOGUE 2013 | EXTERIOR BLINDS

- Technical data
- Diagram
- Installation
- Pricelists of finished products

CONTENTS

	Page
General information	2
Exterior blinds - general information	2
Ext 50 EXTERIOR BLINDS	
Basic pricelist assembly	3
Extras	3
Technical discription	4
C 65 EXTERIOR BLINDS	
Basic pricelist assembly	5
Extras	5
Technical discription	6
C 80 EXTERIOR BLINDS	
Basic pricelist assembly	7
Extras	7
Technical discription	8
Z 70 EXTERIOR BLINDS	
Basic pricelist assembly	9
Extras	9
Technical discription	10
Z 90 EXTERIOR BLINDS	
Basic pricelist assembly	11
Extras	11
Technical discription	12
STANDARD SELF-SUPPORTING SYSTEM	13
SUNKEN GUIDE RAIL	14
ACCESSORIES AND ENHANCEMENTS	
Blinds fixtures range	15
Panel types	15
Types of guide rails	16
INSTALLATION + GEAR UNIT POSITION	17
DIAGRAM	18
CONSTRUCTION READINESS	19
MOTOR CONTROL	
Wiring construction readiness	20
Electric motor connection	20
Unacceptable motor connection	20
Preparation for wiring	21-22
Blinds electric control	23
Blinds remote control	23
INSTALLATION READINESS	24
EXTERIOR BLINDS PRICELIST	

General information

- The figures listed in pricelist refer to **a unit of measure excluding installation**.
- All the price figures have been stated **excluding VAT**.
- Prices shall be determined by the closest larger dimension (with respect to the table figure).
- Figures in tables are stated in millimetres, surface measures in m².
- Any orders shall list **width as the first dimension figure**, followed by the **height figure**.
- These products are provided with a **2-year** warranty. The warranty shall not apply to defects caused by failure to obey the installation instructions, improper **usage** or improper utilization of the product.
- **Any orders** submitted to the manufacturing plant shall be drafted using the **order forms** or via the company website. The company shall not handle any claims submitted in relevance to errors or mistakes incurred on orders in any other form.
- Delivery period 4 weeks, RAL design subject to agreement

Exterior blinds

Ext 50

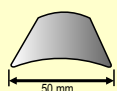

C 65



C 80



Z 70

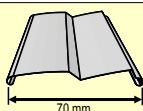

Z 90

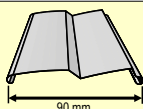

Exterior blinds represent the most frequently used exterior screening features. They allow for continuous regulation of natural lighting, capture of direct sunradiation and help to protect from its harmful effects. These blinds are used not only to screen windows of modern family houses, but also in offices and commercial property. Any requirements for maximum obscuration can be served using the Z-PROFIL slat type, which provides for almost perfect effect. The electric control is more convenient for long-term usage, as such system ensures longer life and options to connect the unit to several different kinds of automatic controls (wind, sun, thermal and time controls). The delivery can be provided with top panels.

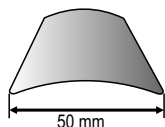

The Ext 50 series is manufactured in two types

- **Exterior model** includes a steel guide line.
- **Interior model** without a steel guide line.

Basic pricelist assembly of Ext 50 blinds

HEADRAIL: steel rail sized 40 x 40 mm in white and silver colour, U-shaped, open upwards

BOTTOM RAIL: steel rail sized 49 x 12 mm in white and silver colour

Control of EXT50: endless cord

Control of INT50 : endless cord, endless chain

TEXTILE COMPONENTS: grey winding band, grey ladder string

SLAT: width of 50 mm, C-shaped, sides without reinforcements

Slat colour: white 50AL01, silver 50AL02, grey 50AL03, ivory 50AL04, beige 50AL05, brown 50AL06, grey-green 50AL07, light green 50AL08, green 50AL09, blue 50AL10, red 50AL11, anthracite gray 50AL12

EXTRAS

HEADRAIL COLOUR: RAL coating

BOTTOM RAIL COLOUR: RAL coating

CONTROL: mechanical: handle with sleeve at 45°, 90°, handle length: 100/105/110/115/120

motor operated: 230V 50 Hz motor including a thermal fuse integrated in the headrail with head and bottom end stops, manufactured by Somfy, Dunkermotoren. Controlled by means of switches or remote transmitters

PANEL: aluminium or RAL paint



In case of motor control, the upper profile is manufactured in the size of 58x56mm, thus the construction is prepared in the same way as with the C80, C65 blinds. Holders 1,2,3,4 are used during the installation. The blind is guided by a string, and anchored with a holder to the window frame or to the floor.

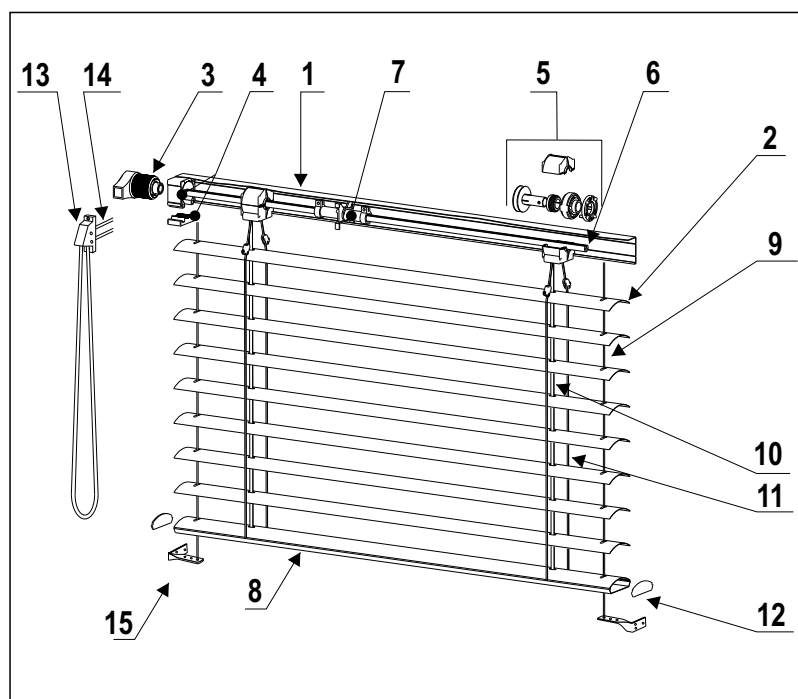

LEGEND

- 1 - headrail
- 2 - slat
- 3 - gear unit
- 4 - gear unit fixture
- 5 - coil
- 6 - shaft
- 7 - end stop
- 8 - bottom rail
- 9 - fixing
- 10 - winding band
- 11 - ladder string
- 12 - bottom rail cover
- 13 - sleeve
- 14 - endless cord
- 15 - string holder

TECHNICAL DATA

MAXIMUM BLIND DIMENSIONS

	Endless cord	Knob	Motor
Max. Width	2500 mm	2500 mm	2500 mm
Min. Width	400 mm	400 mm	600 mm
Max. Height	3200 mm	3200 mm	3000 mm
Min. Height	500 mm	500 mm	500 mm
Max. Surface	6 m ²	8 m ²	8 m ²

RETRACTED BLIND HEIGHT

Blind height	Retracted bale
500	75
510 - 700	85
710 - 1000	105
1010 - 1250	110
1260 - 1500	120
1510 - 1750	130
1760 - 2000	140
2010 - 2250	150
2260 - 2500	160
2510 - 2750	180
2760 - 3000	200

Reveal depth: Minimum : 90 mm

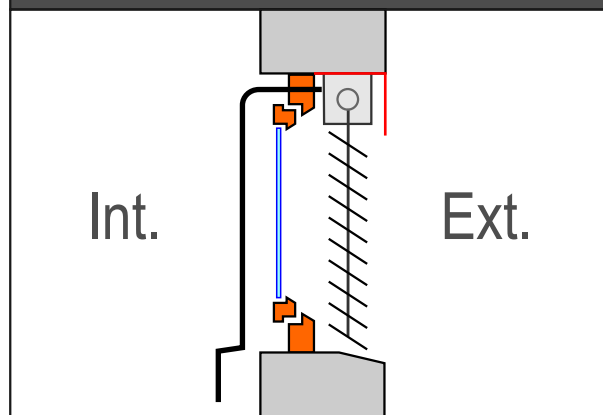

TOP BEAM FIXTURES

Width	No. of fixtures
400 - 1600	2
1610 - 2600	3
2610 - 3300	4
3310 - 4000	5

DRŽÁKY VEDENÍ LANKEM

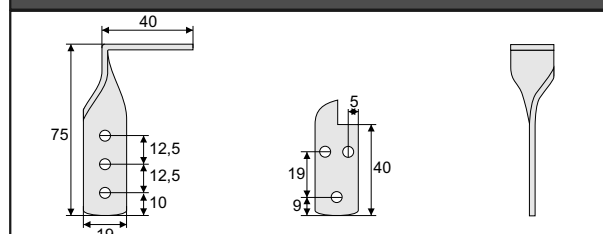

The standard INT 50 blind is manufactured with no fixing line.
If an endless chain is used for control, the gearbox is always located in the position + 20 mm.
The motor control will increase the height of retracted blind approx. 5 cm

GEAR UNIT POSITION

Legend:

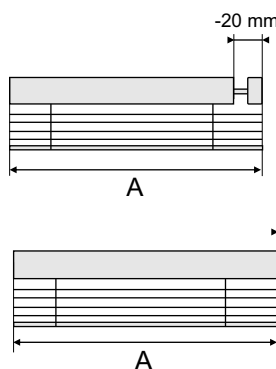
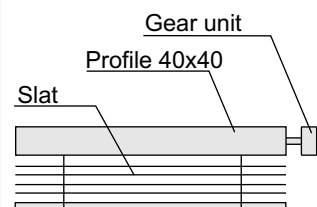

Unless otherwise stated in the order, the gear unit is located at slats i.e. the top rail is 20 mm shorter. (A = default width)

The gear unit can be spaced by the blind width. Such gear unit spacing shall be specified in the order form, see dimension B
(A = default width)
(B = indicates length increment of the top rail, i.e.. + x mm)



Channel fixture types
Panel types
Blinds orientation

page 15
page 15
page 17-19



Basic pricelist assembly of C65 blinds

HEADRAIL: steel profile, 56 x 58 mm silver, galvanised, U-shaped, open downwards

BOTTOM RAIL: aluminium rail, anodized

CONTROL: handle with sleeve at 45°

TEXTILE COMPONENTS: grey winding band, grey ladder string

SLAT: width of 65 mm, C-shaped, slat with bilateral skive made from highly alloyed aluminium

Slat colour: white RAL9010, light beige RAL 1013, beige RAL VSR 240, grey RAL7035, silver RAL9006, dark silver RAL9007, yellow RAL1007, red RAL3004, green RAL6005, light blue RAL5014, brown RAL8014, anthracite gray RAL 7016, Bronze VSR 780

GUIDE RAILS: aluminium (20x20 mm), anodized, double guide rail

CHANNEL FIXTURES: type No. 1

EXTRAS

HEADRAIL COLOUR: RAL coating

BOTTOM RAIL COLOUR: RAL coating

GUIDE RAIL COLOUR: RAL coating

CONTROL: mechanical: handle with sleeve at 90°, handle length: 100/105/110/115/120

motor operated: 230V 50 Hz motor including a thermal fuse integrated in the headrail with the head and bottom end stops manufactured by Somfy, Dunkermotoren. Controlled by means of switches or remote transmitters

PANEL: aluminium, colour identical to slat colour shade or RAL coating

BLINDS FIXTURES: type No. 2, 3, 4

C 65

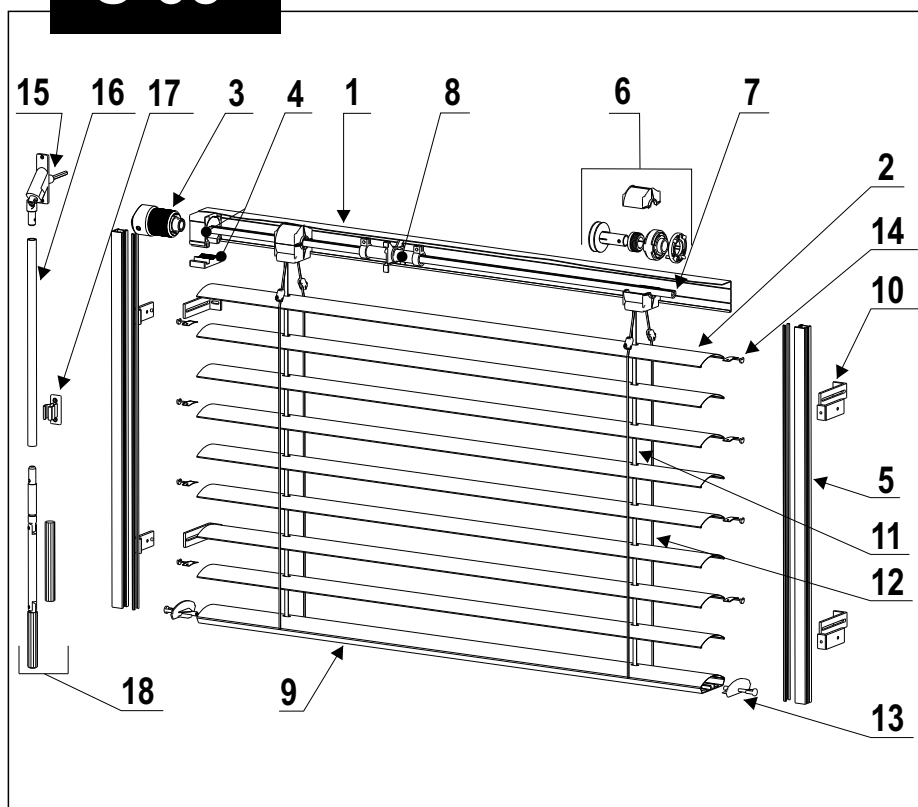
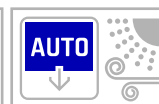

LEGEND

- 1 - headrail
- 2 - slat
- 3 - gear unit
- 4 - gear unit fixture
- 5 - guide rail
- 6 - coil
- 7 - shaft
- 8 - end stop
- 9 - bottom rail
- 10 - guide rail fixture
- 11 - winding band
- 12 - ladder string
- 13 - bottom rail cover
- 14 - guide spindle
- 15 - sleeve
- 16 - handle tube
- 17 - handle fixture

TECHNICAL DATA

MAXIMUM BLIND DIMENSIONS

	Knob	Motor
Max. Width	4000 mm	4000 mm
Min. Width	400 mm	600 mm
Max. Height	4000 m	4000 mm
Min. Height	500 mm	500 mm
Max. Surface	9 m ²	12 m ²

RETRACTED BLIND HEIGHT

Blind height	Retracted bale height	Blind height	Retracted bale height
1010 - 1250	210	2760 - 3000	330
1260 - 1500	230	3010 - 3250	350
1510 - 1750	250	3260 - 3500	370
1760 - 2000	260	3510 - 3750	390
2010 - 2250	280	3760 - 4000	410
2260 - 2500	300	GALLERY	+20
2510 - 2750	320		

Reveal depth:
Minimum : 120 mm

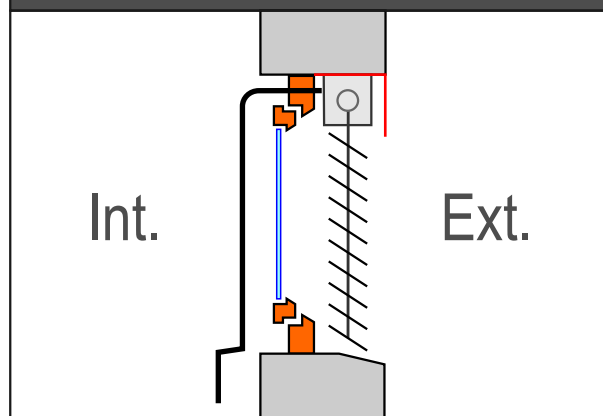

TOP BEAM FIXTURES

Width	No. Of fixtures
400 - 1600	2
1610 - 2600	3
2610 - 3300	4
3310 - 4000	5

Guide rails

Guide rails types

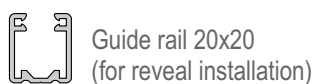
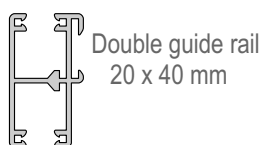

Number of fixtures used depending on blind height

Blind height	No. of guide rail fixtures
600-1600	2
1610-2600	3
2610-4000	4

Guide rail assembly types

SINGLE GUIDE RAIL

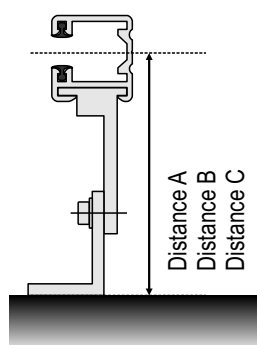

Distance A 50 - 70 mm (standard)
Distance B 71 - 100 mm
Distance C 101 - 145 mm

DOUBLE GUIDE RAIL

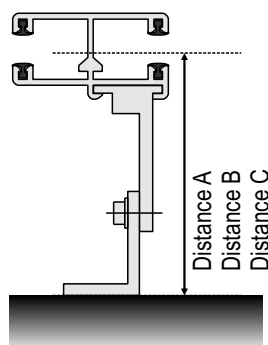

Distance A 50 - 70 mm (standard)
Distance B 71 - 100 mm
Distance C 101 - 145 mm

GUIDE RAIL FOR REVEAL INTEGRATION

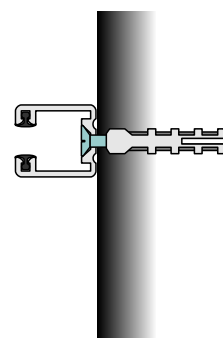

Channel fixture types
Panel types
Blinds orientation

page 15
page 15
page 17-19

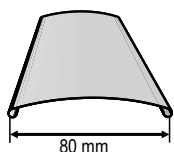

Basic pricelist assembly of C80 blinds

HEADRAIL: steel rail, 56 x 58 mm silver, galvanised, U-shaped, open downwards

BOTTOM RAIL: aluminium rail, anodized

CONTROL: handle with sleeve at 45°

TEXTILE COMPONENTS: grey winding band, grey ladder string

SLAT: width of 80 mm, C-shaped, slat with bilateral skive made from highly alloyed aluminium

Slat colour: white RAL9010, light beige RAL 1013, beige RAL VSR 240, grey RAL7035, silver RAL9006, dark silver RAL9007, yellow RAL1007, red RAL3004, green RAL6005, light blue RAL5014, brown RAL8014, anthracite gray RAL 7016 Bronze VSR 780

GUIDE RAILS: aluminium (20x20 mm), anodized, double guide rail

CHANNEL FIXTURES: type No. 1

EXTRAS

HEADRAIL COLOUR: RAL coating

BOTTOM RAIL COLOUR: RAL coating

GUIDE RAIL COLOUR: RAL coating

CONTROL: mechanical: handle with sleeve at 90°, handle length: 100/105/110/115/120

motor operated: 230V 50 Hz motor including a thermal fuse integrated in the headrail with the head and bottom end stops manufactured by Somfy, Dunkermotoren. Controlled by means of switches or remote transmitters

PANEL: aluminium, colour identical to slat colour shade or RAL coating

BLINDS FIXTURES: type No. 2, 3, 4

C 80

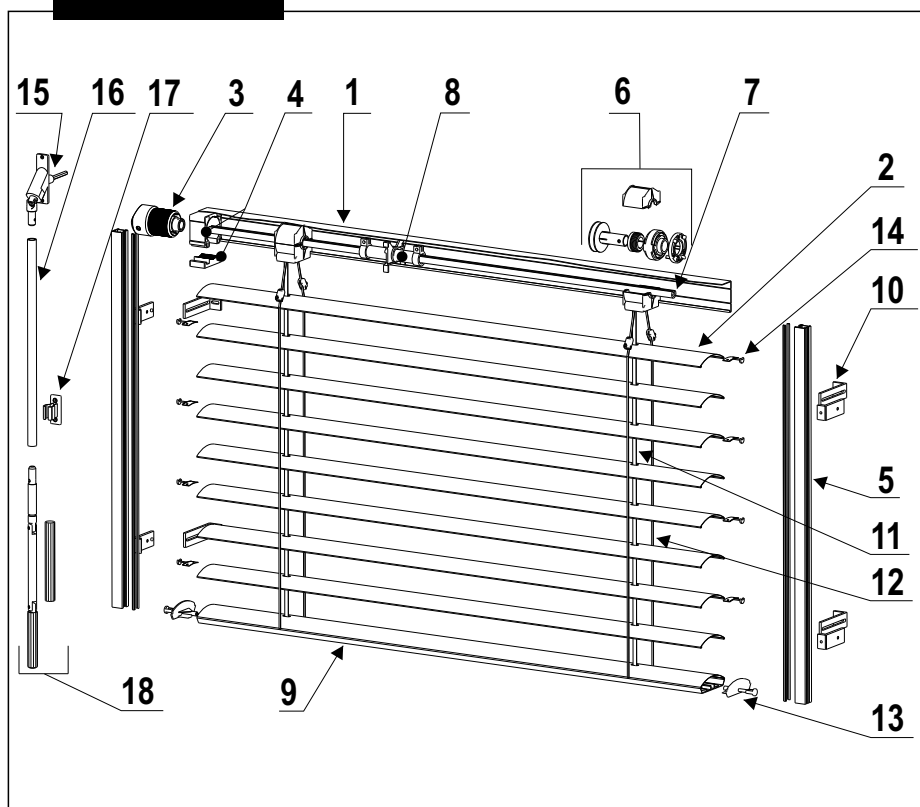

LEGEND

- 1 - headrail
- 2 - slat
- 3 - gear unit
- 4 - gear unit fixture
- 5 - guide rail
- 6 - coil
- 7 - shaft
- 8 - end stop
- 9 - bottom rail
- 10 - guide rail fixture
- 11 - winding band
- 12 - ladder string
- 13 - bottom rail cover
- 14 - guide spindle
- 15 - sleeve
- 16 - handle tube
- 17 - handle fixture

TECHNICAL DATA

MAXIMUM BLIND DIMENSIONS

	Knob	Motor
Max. Width	4000 mm	4000 mm
Min. Width	400 mm	600 mm
Max. Height	4000 m	4000 mm
Min. Height	500 mm	500 mm
Max. Surface	9 m ²	12 m ²

RETRACTED BLIND HEIGHT

Blind height	Retracted bale height	Blind height	Retracted bale height
1010 - 1250	200	2760 - 3000	320
1260 - 1500	220	3010 - 3250	340
1510 - 1750	240	3260 - 3500	360
1760 - 2000	250	3510 - 3750	380
2010 - 2250	270	3760 - 4000	400
2260 - 2500	290	GALLERY	+20
2510 - 2750	310		

Reveal depth:
Minimum : 120 mm

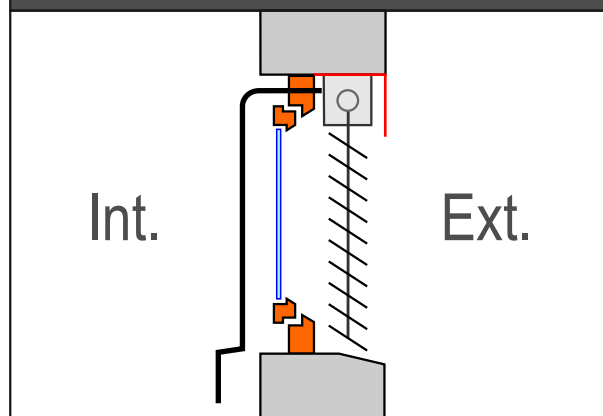

TOP BEAM FIXTURES

Width	No. Of fixtures
400 - 1600	2
1610 - 2600	3
2610 - 3300	4
3310 - 4000	5

Guide rails

Guide rails types

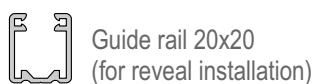
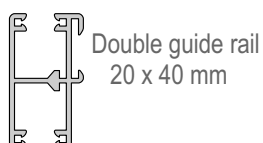

Number of fixtures used depending on blind height

Blind height	No. of guide rail fixtures
600-1600	2
1610-2600	3
2610-4000	4

Guide rail assembly types

SINGLE GUIDE RAIL

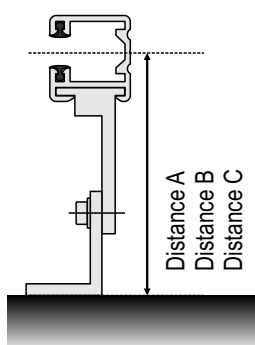

Distance A 50 - 70 mm (standard)
Distance B 71 - 100 mm
Distance C 101 - 145 mm

DOUBLE GUIDE RAIL

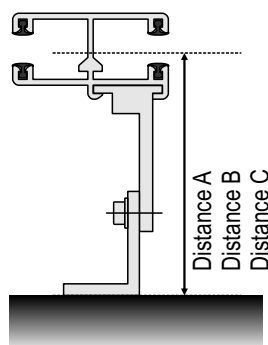

Distance A 50 - 70 mm (standard)
Distance B 71 - 100 mm
Distance C 101 - 145 mm

GUIDE RAIL FOR REVEAL INTEGRATION

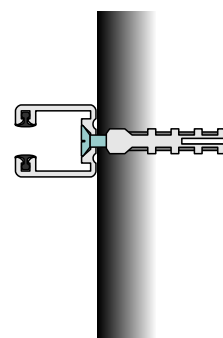

Channel fixture types
Panel types
Blinds orientation

page 15
page 15
page 17-19

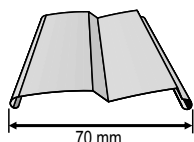

Basic pricelist assembly of Z70 blinds

HEADRAIL: steel rail, 56x58 mm, galvanised, U-shaped, open downwards

BOTTOM RAIL: aluminium rail, anodized

CONTROL: knob with sleeve at 45°

TEXTILE COMPONENTS: grey winding band, grey ladder string

SLAT: width 70 mm, Z-shaped, bilateral skive slats filled with rubber

SLAT COLOUR: white RAL9010, light beige RAL 1013, beige RAL VSR 240, grey RAL7035, silver RAL9006, dark silver RAL9007, yellow RAL1007, red RAL3004, green RAL6005, light blue RAL5014, brown RAL8014, anthracite gray RAL 7016 Bronze VSR 780

GUIDE RAILS: aluminium (20x20 mm), anodized, double guide rail

CHANNEL FIXTURES: type No. 1

Extras

HEADRAIL COLOUR: RAL coating

BOTTOM RAIL COLOUR: RAL coating

GUIDE RAIL COLOUR: RAL coating

CONTROL: mechanical : handle with sleeve at 90°, handle length: 100/105/110/115/120

motor operated : 230V 50 Hz motor including a thermal fuse integrated in the headrail with the head and bottom end stops manufactured by Somfy, Dunkermotoren. Controlled by means of switches or remote transmitters

PANEL: aluminium, colour identical to slat colour shade or RAL coating

BLINDS FIXTURES: type No. 2, 3, 4

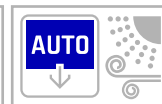

Z 70

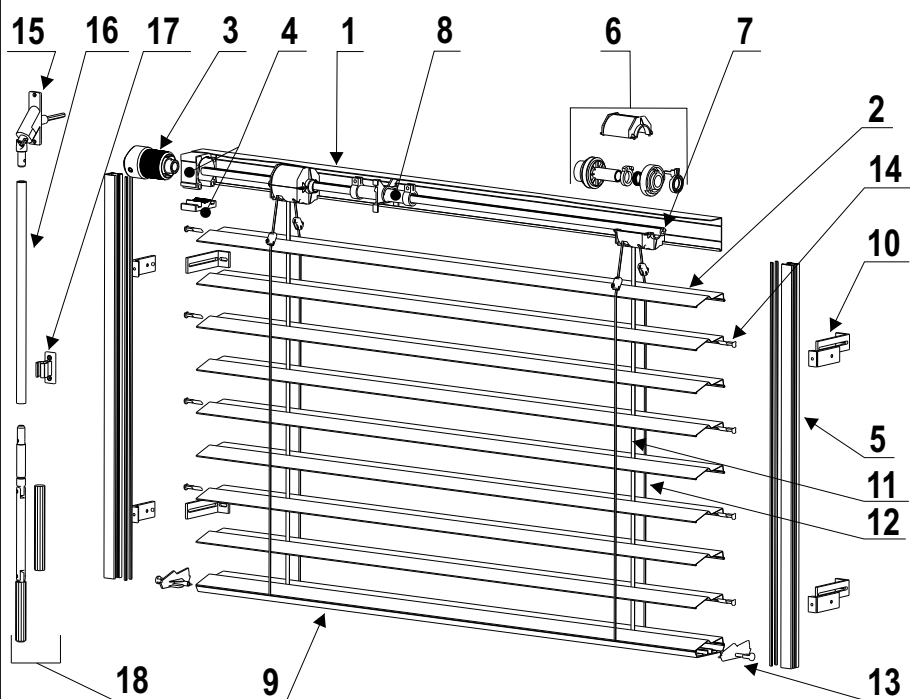

LEGEND

- 1 - headrail
- 2 - slat
- 3 - gear unit
- 4 - gear unit fixture
- 5 - guide rail
- 6 - coil
- 7 - shaft
- 8 - end stop
- 9 - bottom rail
- 10 - guide rail fixture
- 11 - winding band
- 12 - ladder string
- 13 - bottom rail cover
- 14 - guide spindle
- 15 - sleeve
- 16 - handle tube
- 17 - handle fixture
- 18 - handle

TECHNICAL DATA

MAXIMUM BLIND DIMENSIONS

	Knob	Motor
Max. Width	4000 mm	4000 mm
Min. Width	400 mm	600 mm
Max. Height	4000 m	4000 mm
Min. Height	500 mm	500 mm
Max. Surface	9 m ²	12 m ²

RETRACTED BLIND HEIGHT

Blind height	Retracted bale height	Blind height	Retracted bale height
1010 - 1250	190	2760 - 3000	300
1260 - 1500	210	3010 - 3250	320
1510 - 1750	230	3260 - 3500	330
1760 - 2000	240	3510 - 3750	350
2010 - 2250	260	3760 - 4000	360
2260 - 2500	280	GALLERY	+20
2510 - 2750	290		

Reveal depth:
Minimum : 130 mm

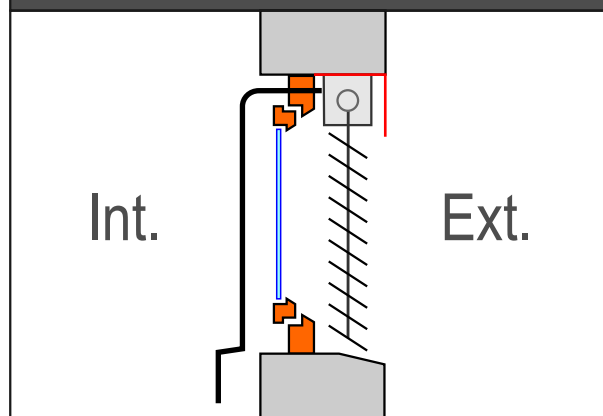

TOP BEAM FIXTURES

Width	No. Of fixtures
400 - 1600	2
1610 - 2600	3
2610 - 3300	4
3310 - 4000	5

Guide rails

Guide rails types

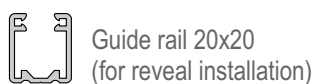
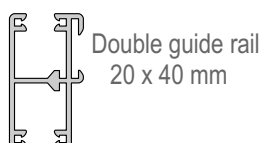

Number of fixtures used depending on blind height

Blind height	No. of guide rail fixtures
600-1600	2
1610-2600	3
2610-4000	4

Guide rail assembly types

SINGLE GUIDE RAIL

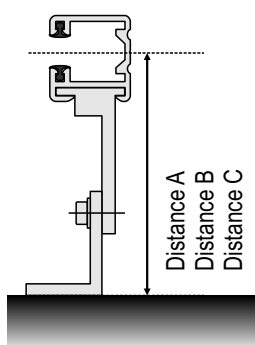

Distance A 50 - 70 mm (standard)
Distance B 71 - 100 mm
Distance C 101 - 145 mm

DOUBLE GUIDE RAIL

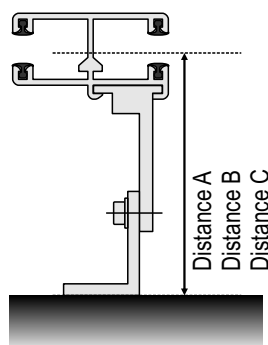

Distance A 50 - 70 mm (standard)
Distance B 71 - 100 mm
Distance C 101 - 145 mm

GUIDE RAIL FOR REVEAL INTEGRATION

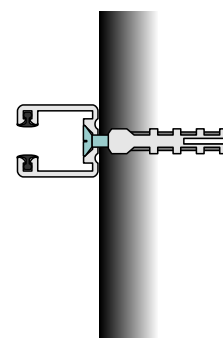

Channel fixture types
Panel types
Blinds orientation

page 15
page 15
page 17-19

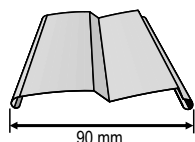

Basic pricelist assembly of Z90 blinds

HEADRAIL: steel rail, 56x58 mm, galvanised, U-shaped, open downwards

BOTTOM RAIL: aluminium rail, anodized

CONTROL: knob with sleeve at 45°

TEXTILE COMPONENTS: grey winding band, grey ladder string

SLAT: width 90 mm, Z-shaped, bilateral skive slats filled with rubber

SLAT COLOUR: white RAL9010, light beige RAL 1013, beige RAL VSR 240, grey RAL7035, silver RAL9006, dark silver RAL9007, yellow RAL1007, red RAL3004, green RAL6005, light blue RAL5014, brown RAL8014, anthracite gray RAL 7016 Bronze VSR 780

GUIDE RAILS: aluminium (20x20 mm), anodized, double guide rail

CHANNEL FIXTURES: type No. 1

Extras

HEADRAIL COLOUR: RAL coating

BOTTOM RAIL COLOUR: RAL coating

GUIDE RAIL COLOUR: RAL coating

CONTROL: mechanical : handle with sleeve at 90°, handle length: 100/105/110/115/120

motor operated : 230V 50 Hz motor including a thermal fuse integrated in the headrail with the head and bottom end stops manufactured by Somfy, Dunkermotoren. Controlled by means of switches or remote transmitters

PANEL: aluminium, colour identical to slat colour shade or RAL coating

BLINDS FIXTURES: type No. 2, 3, 4

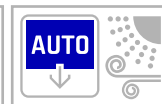

Z 90

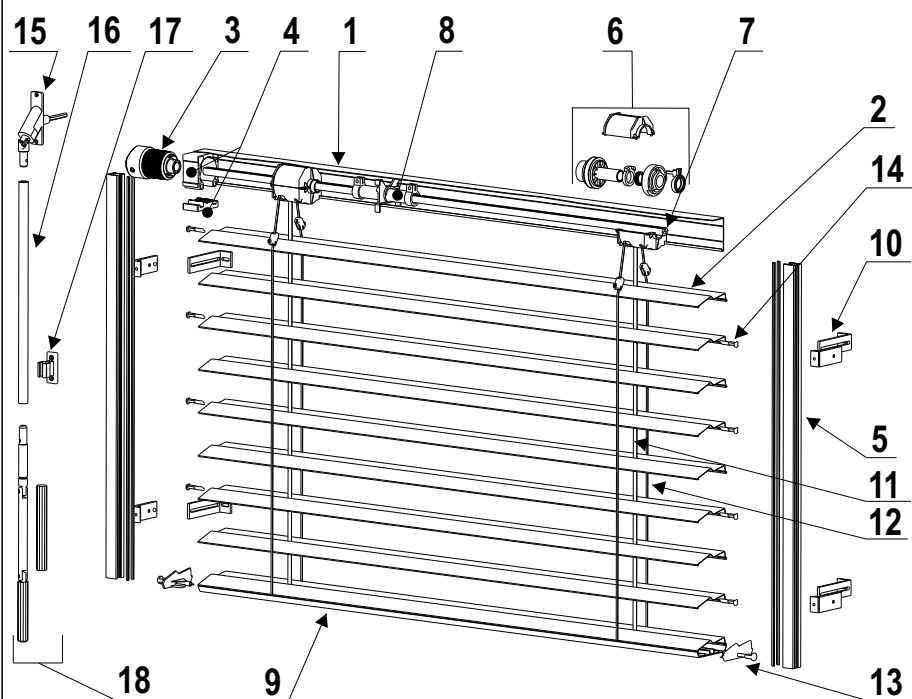

LEGEND

- 1 - headrail
- 2 - slat
- 3 - gear unit
- 4 - gear unit fixture
- 5 - guide rail
- 6 - coil
- 7 - shaft
- 8 - end stop
- 9 - bottom rail
- 10 - guide rail fixture
- 11 - winding band
- 12 - ladder string
- 13 - bottom rail cover
- 14 - guide spindle
- 15 - sleeve
- 16 - handle tube
- 17 - handle fixture
- 18 - handle string

TECHNICAL DATA

MAXIMUM BLIND DIMENSIONS

	Knob	Motor
Max. Width	4000 mm	4000 mm
Min. Width	400 mm	600 mm
Max. Height	4000 m	4000 mm
Min. Height	500 mm	500 mm
Max. Surface	9 m ²	12 m ²

RETRACTED BLIND HEIGHT

Blind height	Retracted bale height	Blind height	Retracted bale height
1010 - 1250	180	2760 - 3000	290
1260 - 1500	200	3010 - 3250	310
1510 - 1750	220	3260 - 3500	320
1760 - 2000	230	3510 - 3750	340
2010 - 2250	250	3760 - 4000	350
2260 - 2500	270	GALERIE	+20
2510 - 2750	280		

Reveal depth: Minimum : 130 mm

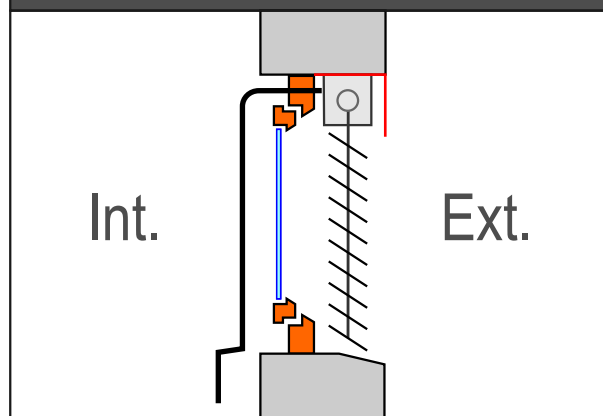

TOP BEAM FIXTURES

Width	No. Of fixtures
400 - 1600	2
1610 - 2600	3
2610 - 3300	4
3310 - 4000	5

Guide rails

Guide rails types

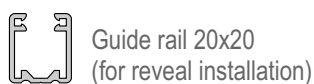
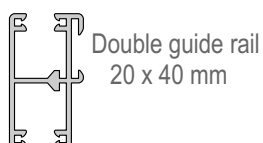

Number of fixtures used depending on blind height

Blind height	No. of guide rail fixtures
600-1600	2
1610-2600	3
2610-4000	4

Guide rail assembly types

SINGLE GUIDE RAIL

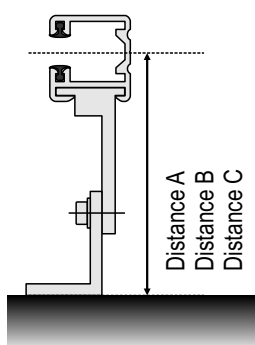

Distance A 50 - 70 mm (standard)
Distance B 71 - 100 mm
Distance C 101 - 145 mm

DOUBLE GUIDE RAIL

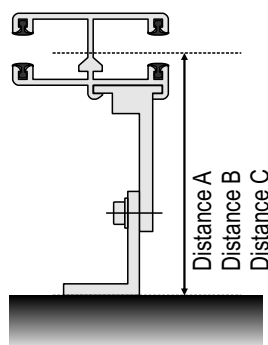

Distance A 50 - 70 mm (standard)
Distance B 71 - 100 mm
Distance C 101 - 145 mm

GUIDE RAIL FOR REVEAL INTEGRATION

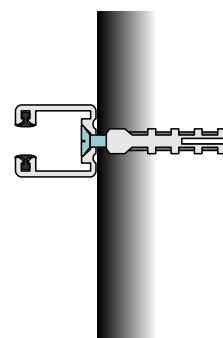

Channel fixture types
Panel types
Blinds orientation

page 15
page 15
page 17-19

STANDARD SELF-SUPPORTING SYSTEM - STS

C 65

C 80

Z 70

Z 90

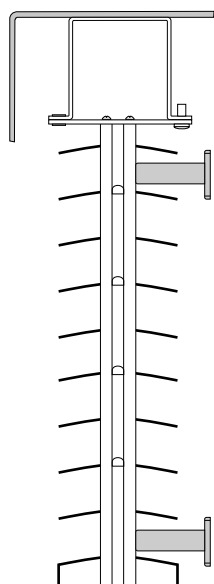
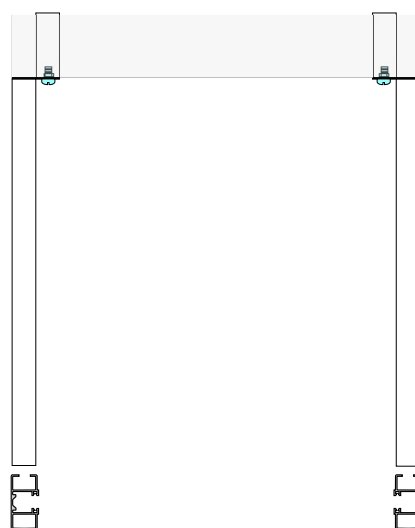
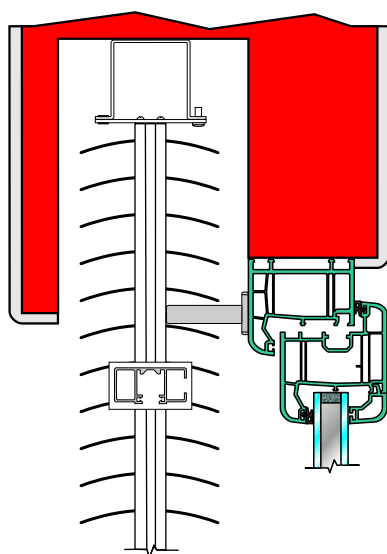

LIMIT DIMENSIONS OF A SELF-SUPPORTING SYSTEM (cm)

control type	min. width	max. width	max. height
rod	50	250	400
motor	50	250	400

NUMBER OF BRACES FOR GUIDE RAILS

height of blinds	number of braces
160 cm	2
260 cm	3
400 cm	4

UPPER PROFILE HOLDER

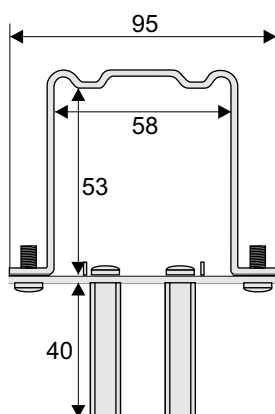

SUNKEN GUIDE RAIL

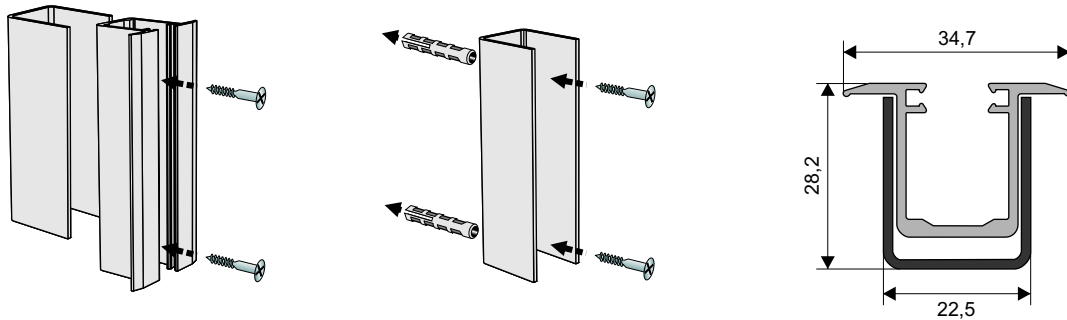

The guide foot is anchored to the bush with a screw; the diameter should be as little as possible (3x30 mm, countersunk head) so that the slat shafts will not catch during upward and downward movement.

Recessed blinds casing with a sunken guide rail - **STANDARD ASSEMBLY**

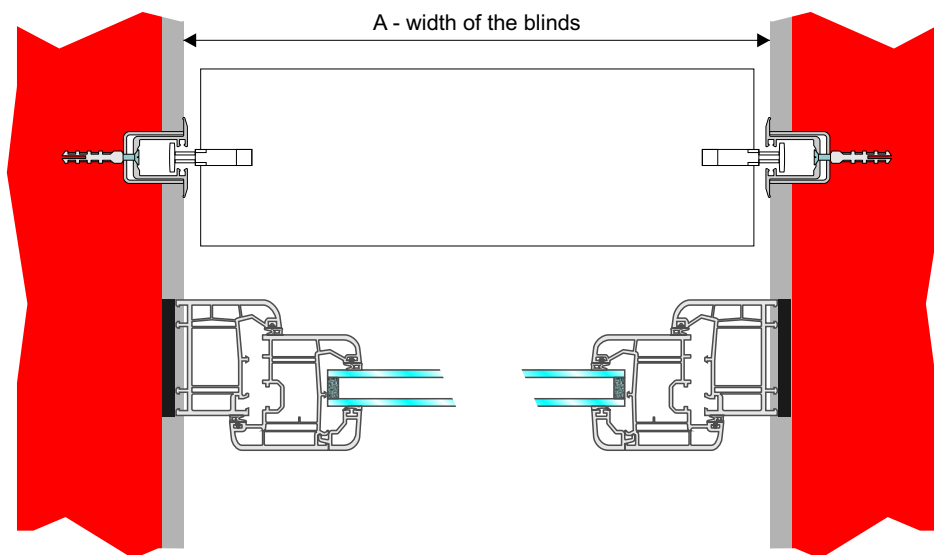

Recessed blinds casing with a sunken guide rail - **IN REVEAL WITH BRACE**

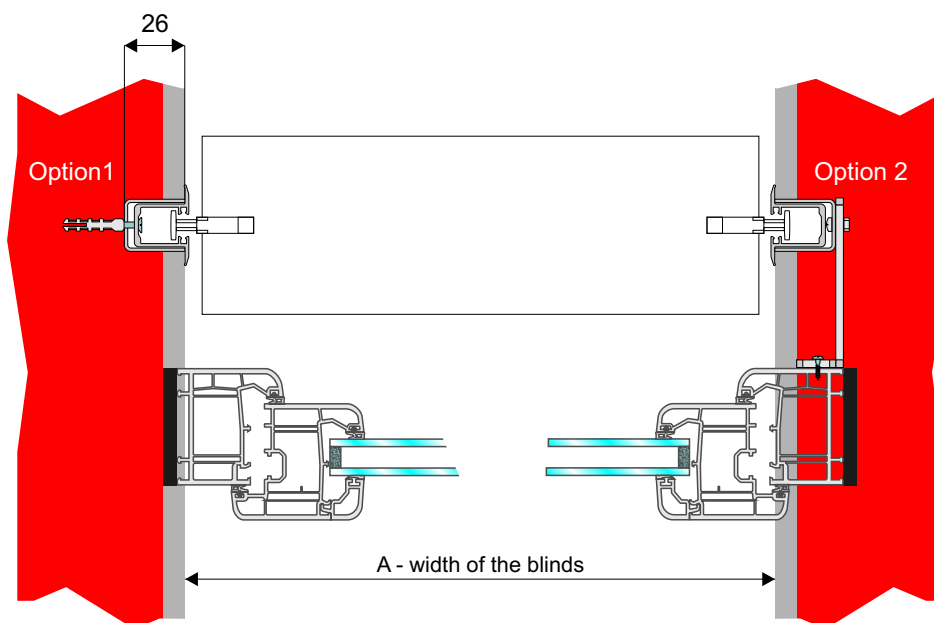

ACCESORIES AND ENHANCEMENTS - FIXTURE TYPES

FIXTURE TYPES

Ext 50

Fixture No.1
Ceiling installation
Ceiling fixture

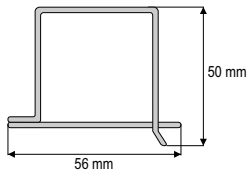

Fixture no.2
Wall installation
Versatile fixture

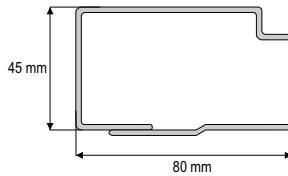

Fixture No.3
Panel installation
Panel fixture (on wall and ceiling)

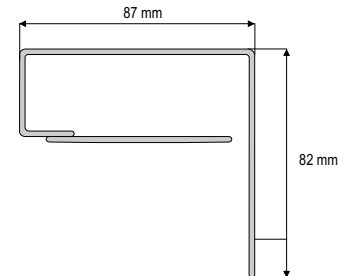

C 65

C 80

Z 70

Z 90

Fixture No.1
Simple channel fixture

standard

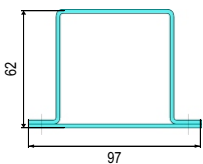

automatic

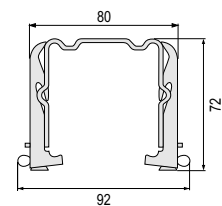

Fixture No.2
Channel fixture with wall
mount

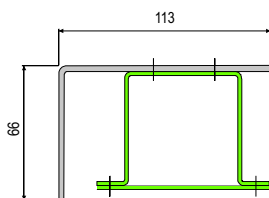

Fixture No.3
Versatile fixture for wall or ceiling
installation including panel

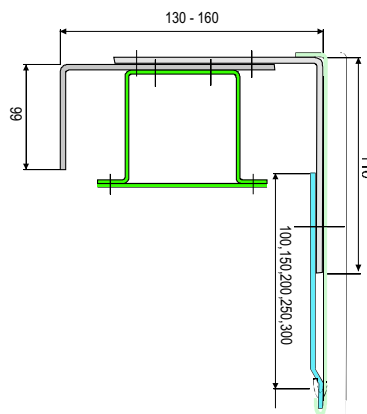

Fixture No.4
Ceiling installation fixture
including panel

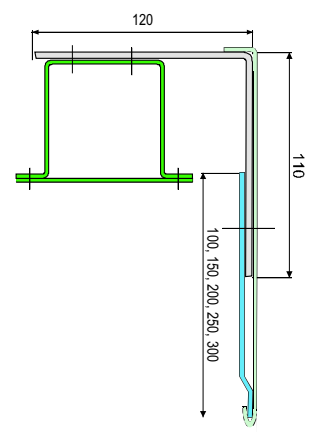

COVER PLATES

A - cover height B - bend width

Type 1

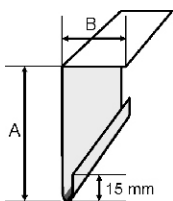

Type 2

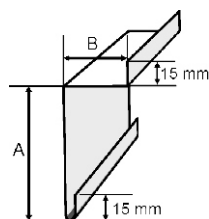

Type 3

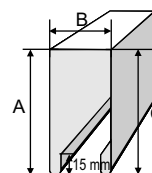

Type 4

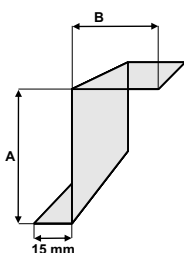

Type 5

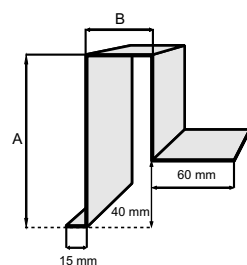

**Panel side
of plate**

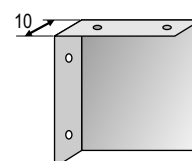

Ext 50

C 65

C 80

Z 70

Z 90

TYPES OF GUIDE RAILS

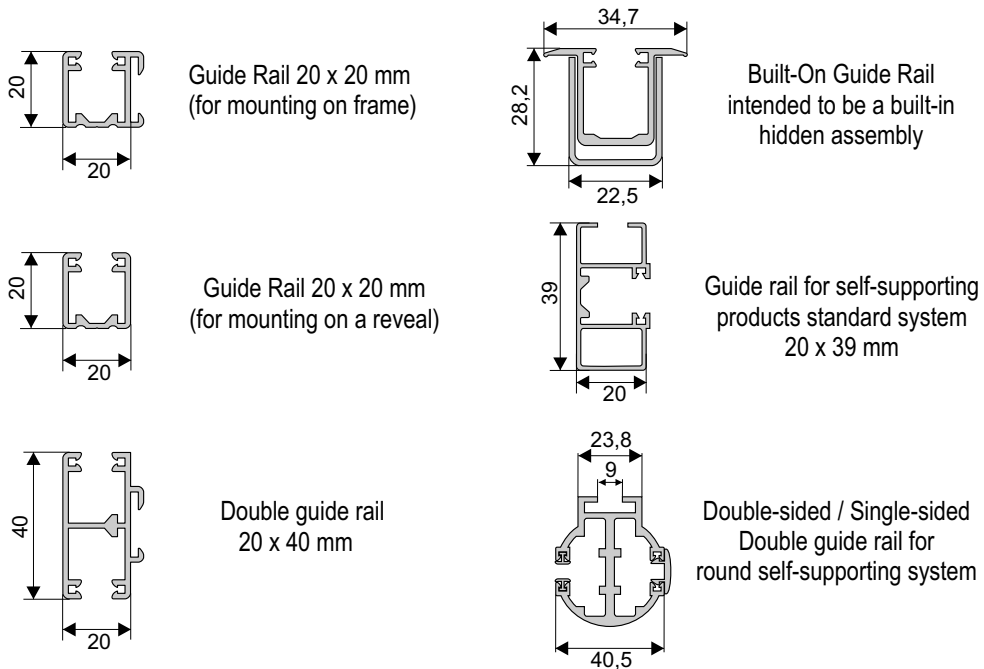

TYPES BRACKETS FOR GUIDE RAILS

STANDARD BRACKET

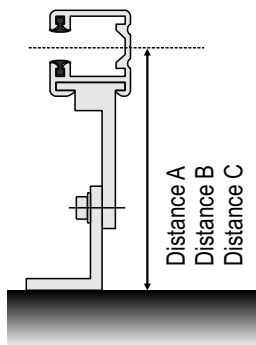

Distance A 50 - 70 mm (standard)
Distance B 71 - 100 mm
Distance C 101 - 145 mm

TELESCOPING BRACKET

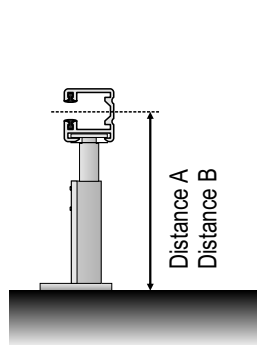

Distance A 57 - 77 mm
Distance B 78 - 112 mm

TELESCOPING BRACKET

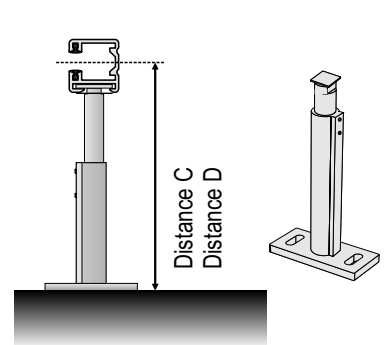

Distance C 113 - 177 mm
Distance D 171 - 295 mm

TELESCOPING BRACKET FOR ROUND SELF-SUPPORTING SYSTEM

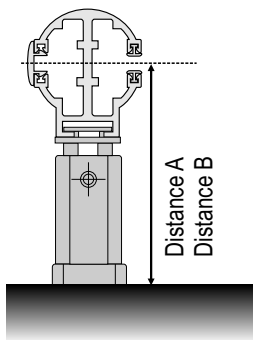

Distance A 55 - 75 mm
Distance B 75 - 120 mm

BRACKETS AT THE PLACE OF MOUNTING TO THE WINDOW FRAME

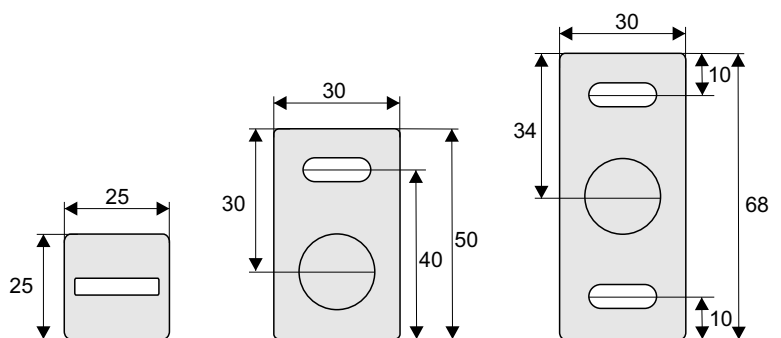

INSTALLATION + GEAR UNIT POSITION

EXAMPLE OF INSTALLATION

C 65

C 80

Z 70

Z 90

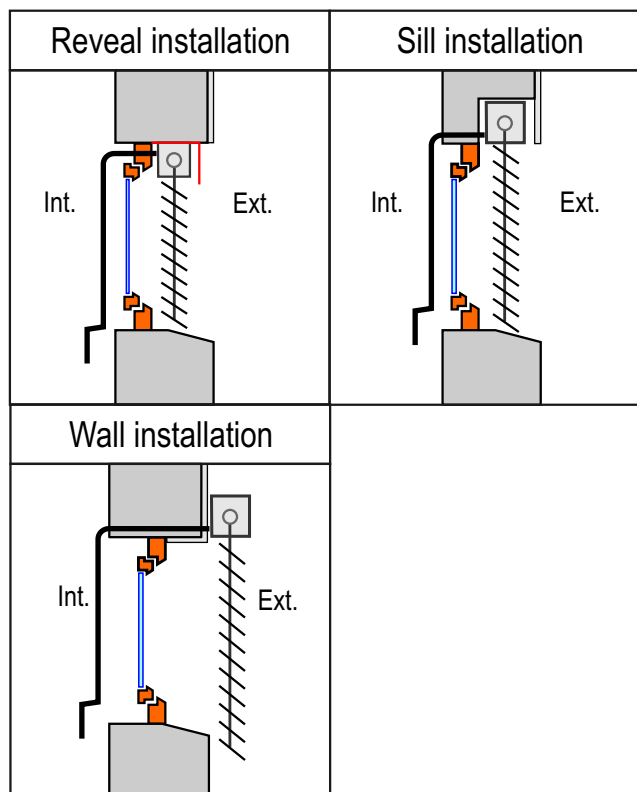
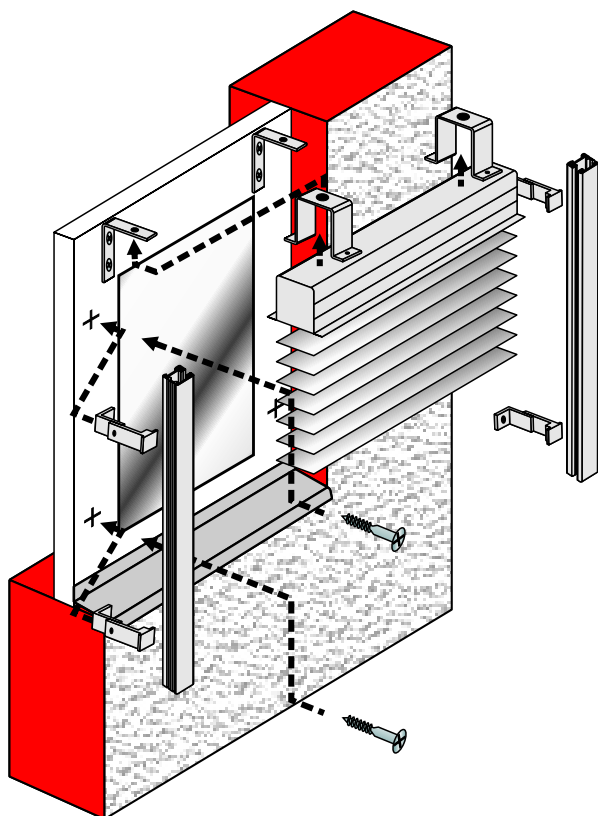

GEAR UNIT POSITION

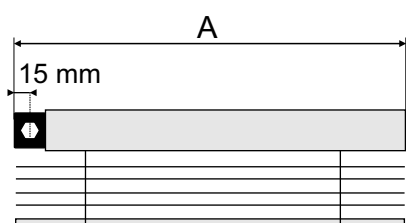

standard version of gear unit position
- left control

A = blind width

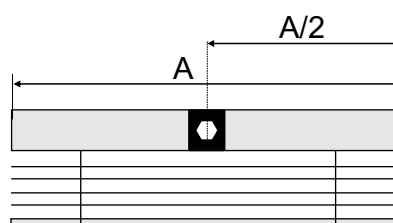

gear unit position on the centre of blind

A = blind width

(indicate central measurement in the order)

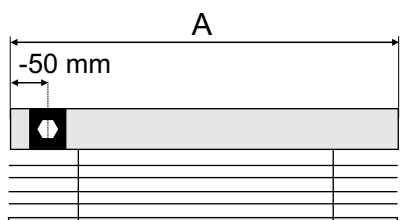

gear unit position in -50 mm
- left control

A = blind width

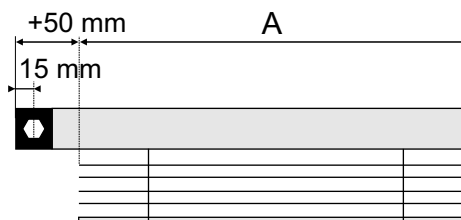

gear unit position in +50 mm
- left control

A = blind width

(during measurement we have to take into account that hole for guide is shifted back 15 mm)

C 65

C 80

Z 70

Z 90

DIAGRAM - reveal installation

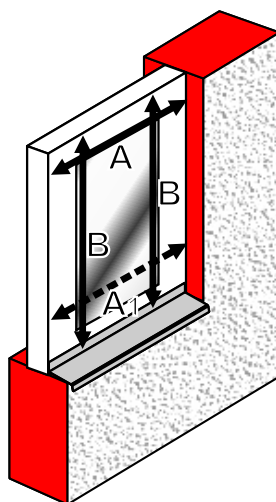
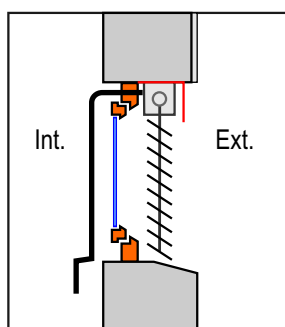

Ext 50 C 65 C 80 Z 70 Z 90

LEGEND:

BLIND WIDTH = A

A1 = blind width check (in case of A1 smaller than A, enter the blind width according to A1)

BLIND HEIGHT = B

DIAGRAM - sill installation

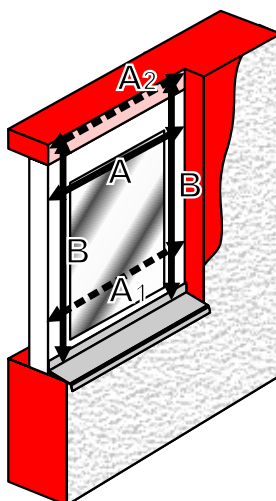
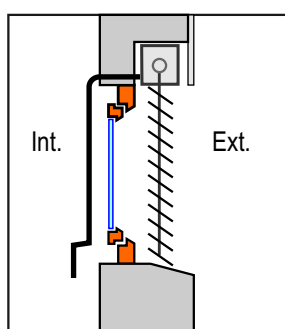

Ext 50 C 65 C 80 Z 70 Z 90

LEGEND:

BLIND WIDTH = A

A1, A2 - blind width check (in case A1 or A2 smaller than A, enter the blind width according to the smallest dimension)

BLIND HEIGHT = B

DIAGRAM - wall installation

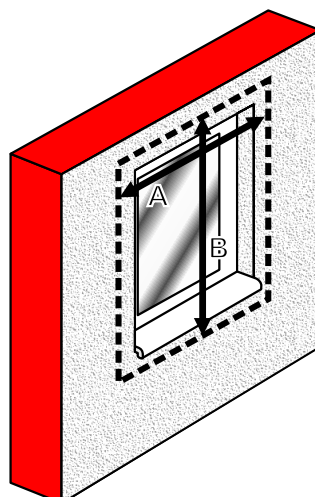
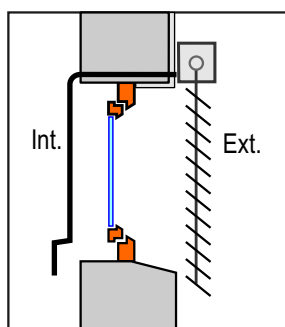

Ext 50 C 65 C 80 Z 70 Z 90

LEGEND:

BLIND WIDTH = A

BLIND HEIGHT = B

The height of retracted slats shall be observed

CONSTRUCTION READINESS

CONSTRUCTION READINESS : manual control output

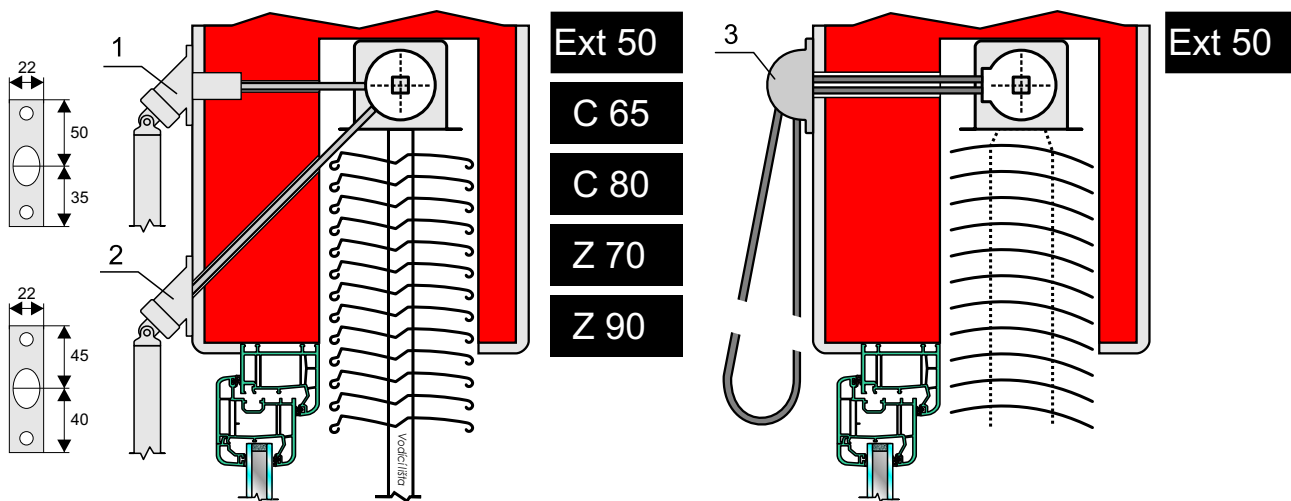

i 1 - HANDLE WITH OUTPUT AT 90°
ENTRY Ø 13mm

2 - HANDLE WITH OUTPUT AT 45°
ENTRY Ø 10mm

i 3 - ENDLESS CORD

i length of gear unit – standard 300 mm, extras for 500/1000 mm

CONSTRUCTION READINESS : motor power supply output

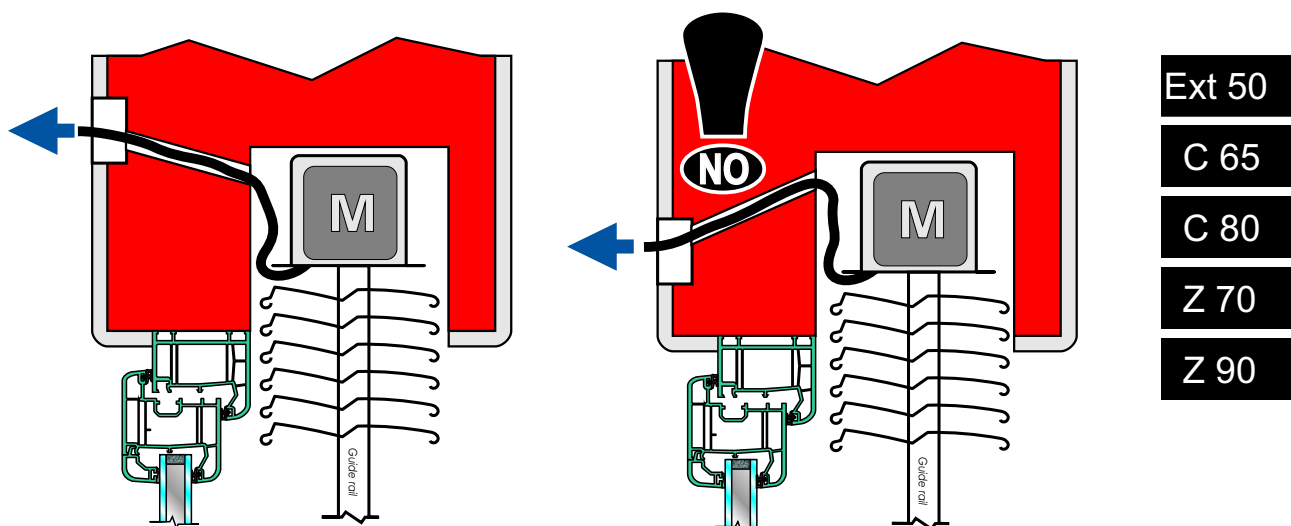

i This setup complies with all the standard safety requirements.

i This setup may become a trap for potential condensed water

MOTOR OPERATED CONTROL

ELECTRIC MOTOR CONNECTION

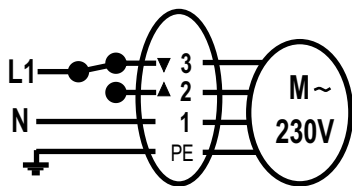

STAS SOCKET CONNECTION DIAGRAM

- 1 blue zero conductor
- 2 black phase conductor (up)
- 3 brown phase conductor (down)
- PE green-yellow protective conductor

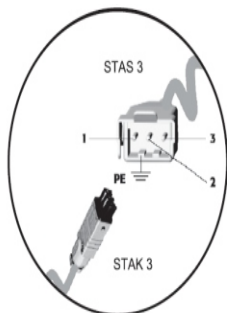

Ext 50

C 65

C 80

Z 70

Z 90

MOTOR TECHNICAL DATA

Motor type	Surface	W	A
3 Nm	8 m ²	105	0,47
6 Nm	18 m ²	90	0,40
10 Nm	21 m ²	135	0,60

WIRING CONSTRUCTION READINESS

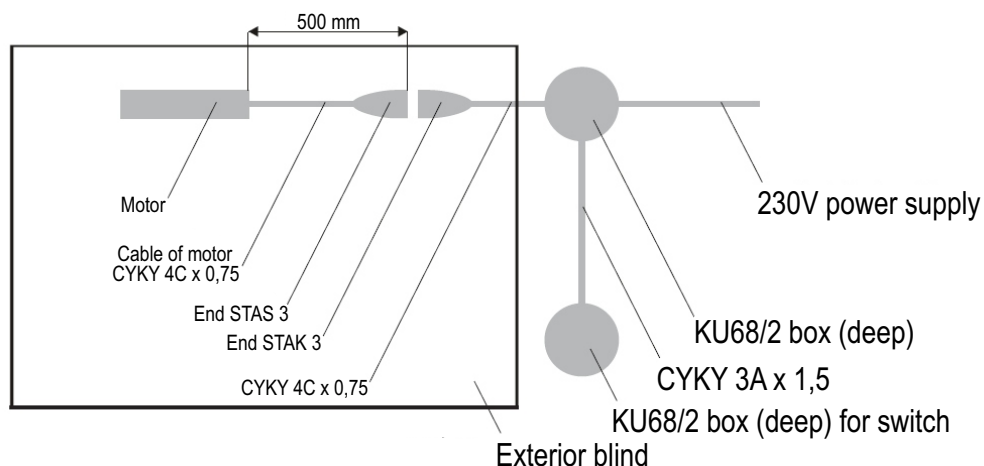

UNACCEPTABLE MOTOR CONNECTION

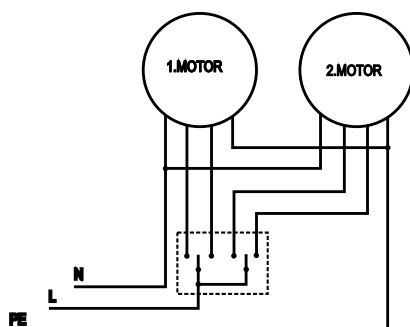

CORRECT MOTOR CONNECTION

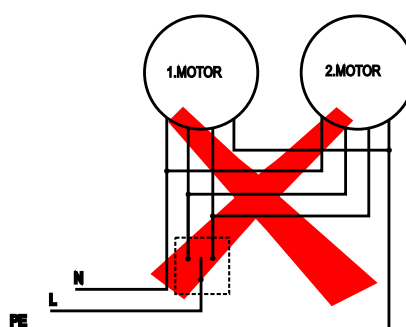

UNACCEPTABLE MOTOR CONNECTION



Any electrical installations, connections and setting of motors into operation may be performed by personnel in possession of certificates issued pursuant to provisions of the Ordinance No. 50/78 Coll., §6!



PREPARATION FOR WIRING

The preparation for wiring is done according to the customer's requests. It can be divided into four basic groups:

- Control by means of a local switch without additional demands on automatics or central switching.
- Control by means of a local switch in combination with central control or automatics.
- Intelligent control.
- Radio control by means of remote controllers.

Control by means of a local switch without additional demands on automatics or central switching:

- If this type of control is used, a junction box can be used during wiring preparation at the upper part of the window, where the cable can be led out to the external jalousie (CYKY 5Cx1,5 mm²). From the junction box, continue to the switch (CYKY 3A x1,5 mm²). In the external part, lead the cable of the approximate. length of 1.5 m through the bushing.
- If the 230V distribution is led through switch boxes, the jalousie outlet can be led out from the switch directly without using a junction box, by means of a cable (CYKY 5Cx1,5 mm²), observing the above criteria.

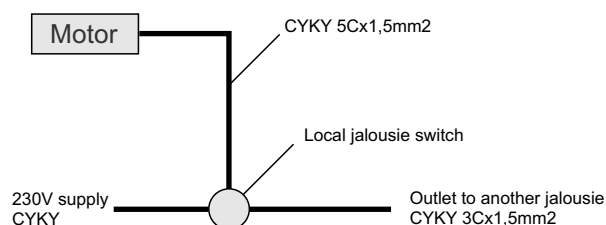
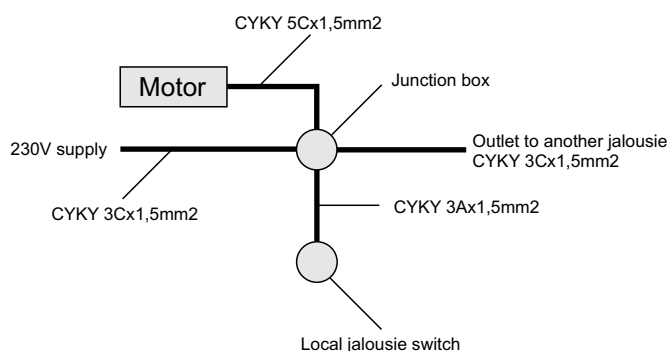

Control by means of a local switch in combination with central control or automatics:

- If the jalousie control design requires central control, it is most suitable to use a deep junction box (KU68 in the upper part of the window or in the soffit) and another one for the switch. In the given object, a place must be chosen from which to control all the jalousies with a central command. From that place, cable is led to the first junction box, and further looped as far as the last jalousie. Use a cable (CYKY 5Cx1,5 mm²) for the distribution, including the junction box – switch connection. Supply 230V voltage to the box in which the central controller is to be located with a cable (CYKY 3Cx1,5 mm²). If wind or solar automatics is used, the automatics outlet is to be terminated at the central switch with a conductor (3X0,8 mm² of network distribution). In the external part, lead a cable out of the junction box through the bushing (CYKY 5Cx1,5 mm²), of the length of approx. 1.5 m.

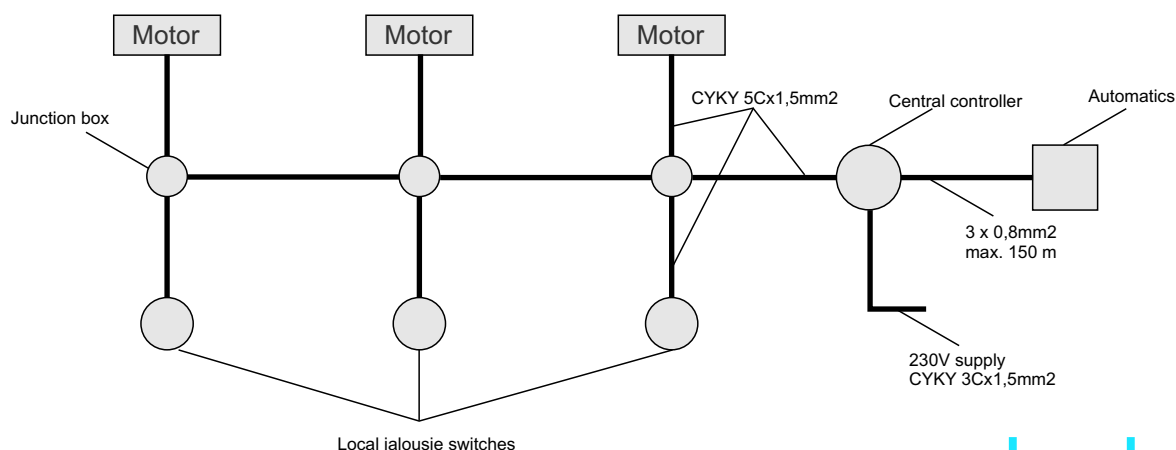

PREPARATION FOR WIRING

Intelligent control:

- In the objects of such a type where the so-called intelligent control (actors combined with a PC) is used, the outlets of all jalousies must be led to the distribution box in which the control is located, by means of a cable (CYKY 5Cx1,5 mm²). Each jalousie is connected to an actor, the commands should be mutually blocked in the equipment (interconnected via a break contact) for the upward and downward direction to prevent damage of the drive.

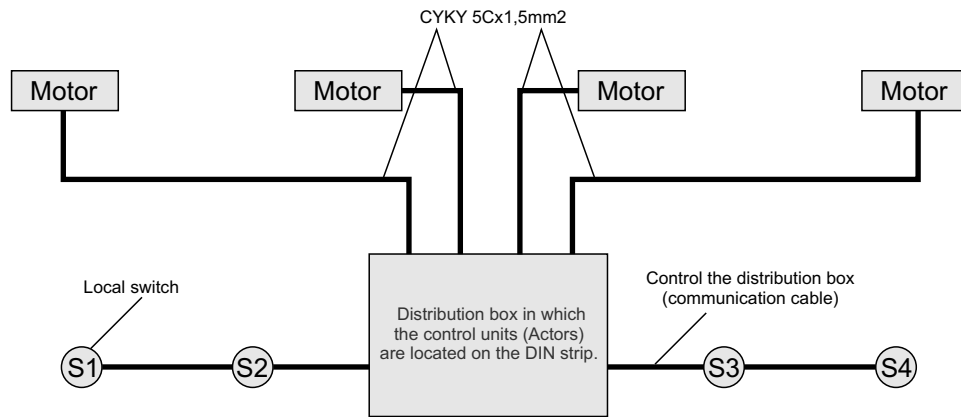

Radio control by means of remote controllers:

- The radio control is the most comfortable. Various control elements can be chosen (central switching, automatics). All is set remotely through controllers of the types used. Installing the wiring, locate a junction box at every jalousie and only loop the 230V supply voltage, including the outlet in the external part to the jalousie. For the distribution, use a cable (CYKY 3Cx1,5 mm²); also, lead the above mentioned cable for the 230V supply to the place where the automatics outlet is to be located.

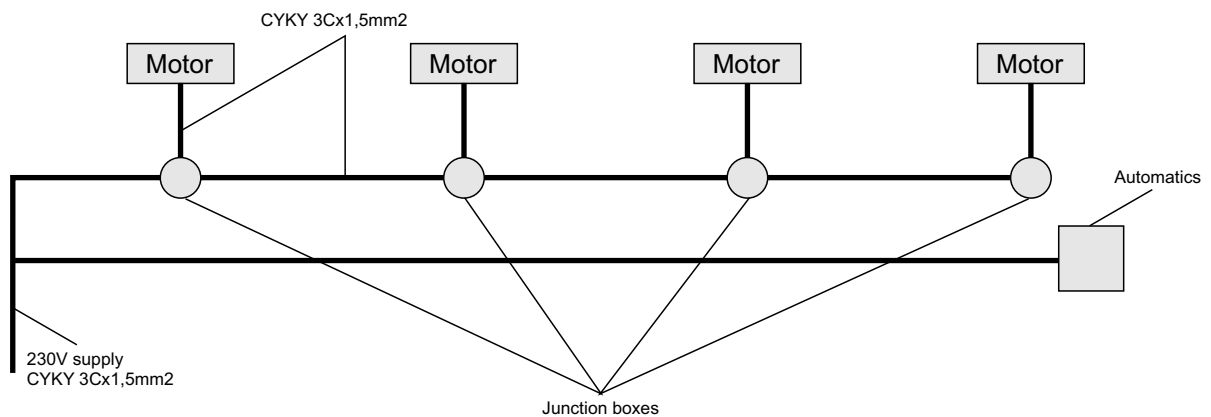

MOTOR OPERATED CONTROL

BLINDS ELECTRICAL CONTROL

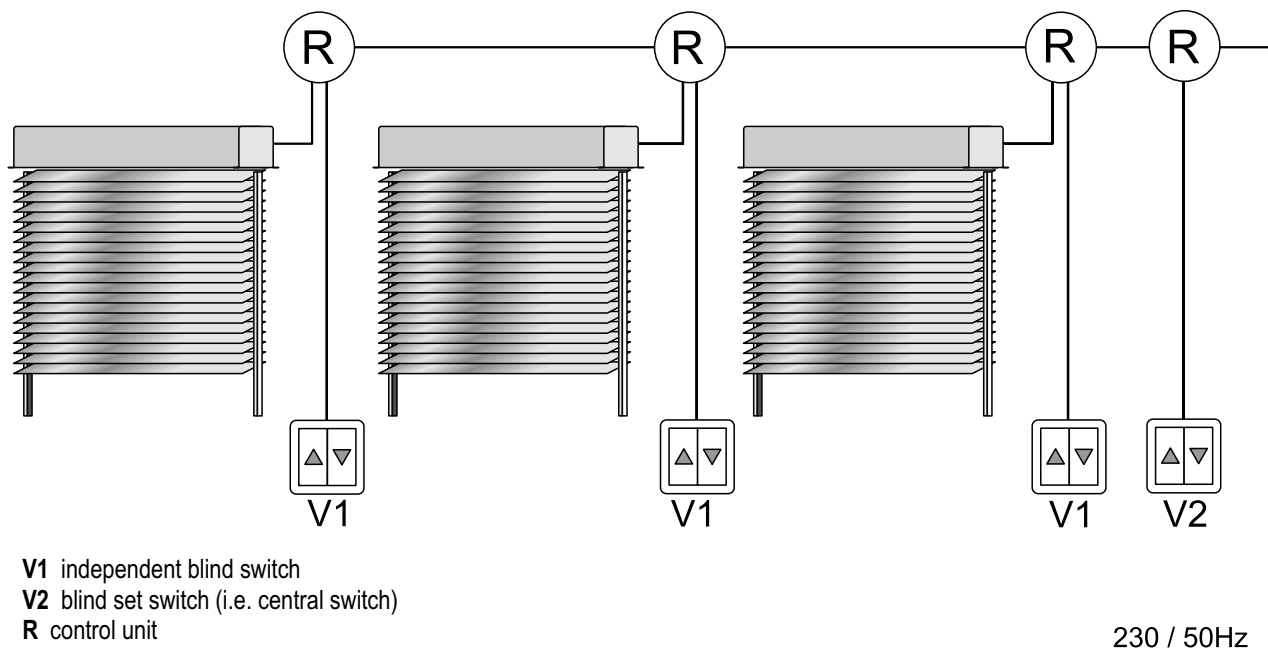

BLINDS REMOTE CONTROL

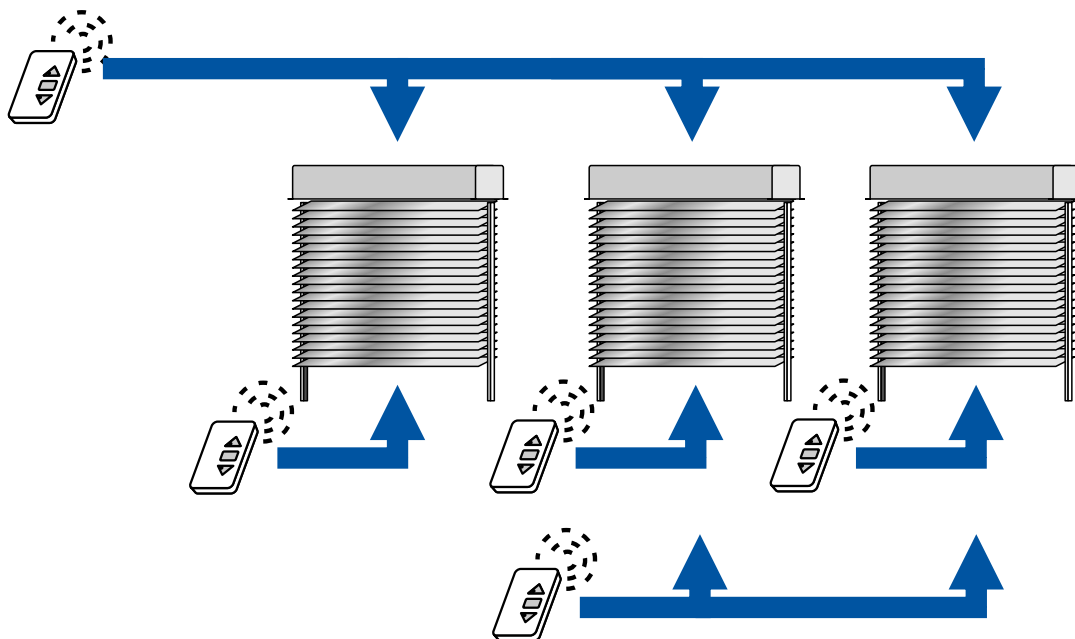

Motor operated blinds with receiver

This solution does not require any further cables, (except for motor power supply), it also enables additional re-programming of transmitters.

FRS transmitters are supplied as "wall mounted" switch units, portable single - or four-channels types.

A single-channel FRS transmitter controls a single shutter or a single set of shutters.

A four-channel FRS transmitter controls four different shutters independently or together as a set.

INSTALATION SPACE CALCULATION FOR EXTERIOR BLIND HOLDERS C65, C80, Z70, Z90

Winder (reel) number	2			2			3										4										5																																																																																																																																																																												
WIDTH A	50 cm	60 cm	70 cm	80 cm	90 cm	100 cm	110 cm	120 cm	130 cm	140 cm	150 cm	160 cm	170 cm	180 cm	190 cm	200 cm	210 cm	220 cm	230 cm	240 cm	250 cm	260 cm	270 cm	280 cm	290 cm	300 cm	310 cm	320 cm	330 cm	340 cm	350 cm	360 cm	370 cm	380 cm	390 cm	400 cm																																																																																																																																																																			
<div><div>guided in rails</div><div>MOTOR: B=A-17 MANUAL: B=A-31</div></div> <div><div>guided by string</div><div>MOTOR: B=A-12 MANUAL: B=A-26</div></div>																																								<div><div>guided in rails</div><div>B=A-31</div></div> <div><div>guided by string</div><div>B=A-26</div></div>																																								<div><div>guided in rails</div><div>B = $\frac{A-40}{2}$</div></div> <div><div>guided by string</div><div>B = $\frac{A-35}{2}$</div></div>																																								<div><div>guided in rails</div><div>B = $\frac{A-40}{3}$</div></div> <div><div>guided by string</div><div>B = $\frac{A-35}{3}$</div></div>																																								<div><div>guided in rails</div><div>B = $\frac{A-40}{4}$</div></div> <div><div>guided by string</div><div>B = $\frac{A-35}{4}$</div></div>																																							

Legend:

A - blind width

B - dimension between individual winders (to the belt centre)

Info - if the handle manual control reaches the blind centre, the reel can be shifted by 10 cm.



- winder (width 8 cm)



- motor location selection (max. motor width 37 cm)

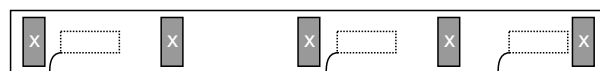

left motor

central motor

right motor



**interior
view**



left motor

central motor

right motor

INSTALLATION SPACE CALCULATION FOR EXTERIOR BLIND HOLDERS EXT50/INT50 (including motor design)

Winder (reel) number	2								3												4			
WIDTH A	50 cm	60 cm	70 cm	80 cm	90 cm	100 cm	110 cm	120 cm	130 cm	140 cm	150 cm	160 cm	170 cm	180 cm	190 cm	200 cm	210 cm	220 cm	230 cm	240 cm	250 cm			
<div><div><div><div><div><div></div><div>A (50-110)</div><div></div></div><div><div><div></div><div></div><div></div></div><div><div><div></div><div></div><div></div></div></div><div><div><div></div><div>15</div><div></div><div>B</div><div></div><div>15</div></div></div></div><div><div>B=A-30</div></div></div><div><div><div><div><div><div></div><div>A (111 - 210)</div><div></div></div><div><div><div></div><div></div><div></div></div><div><div><div></div><div></div><div></div></div></div><div><div><div></div><div>15</div><div></div><div>B</div><div></div><div>B</div><div></div><div>15</div></div></div></div><div><div>$B = \frac{A-30}{2}$</div></div></div><div><div><div><div><div><div></div><div>A (211 - 250)</div><div></div></div><div><div><div></div><div></div><div></div></div><div><div><div></div><div></div><div></div></div></div><div><div><div></div><div>15</div><div></div><div>B</div><div></div><div>B</div><div></div><div>B</div><div></div><div>15</div></div></div></div><div><div>$B = \frac{A-30}{3}$</div></div></div></div></div></div></div></div></div></div></div></div>																								

Legend:

A - blind width

B - dimension between individual winders (to the belt centre)



- winder (width 2.6 cm)